

# QUINN LITE-PAC Pearl

Quinn Lite Pac Pearl is one of a range of expanded polystyrene insulation boards we manufacture for domestic and commercial floor applications

## Benefits of Quinn Lite Pac Pearl

- Quinn Lite Pac Pearl is a closed cell expanded polystyrene (EPS) insulation board suitable for use in all floor constructions.
- Available in compressive strengths of 70Kpa and 100Kpa to suit domestic to commercial applications
- Quinn Lite Pac Pearl is certified by the British Board of Agrément (BBA) and the Irish board of Agrément (IAB).
- Quinn Lite Pac Pearl can be used with underfloor heating systems.
- When installed correctly Quinn Litepac boards have a service life comparable to that of the building.

### Composition

Quinn Lite Pac EPS Pearl is manufactured by using steam to expand polystyrene beads to approximately forty times their original size. As the beads expand the bond and can then be moulded to the required shape. Quinn Lite Pac Pearl is manufactured using advanced EPS polymers which offer improved thermal performance.

### Thermal Performance

Quinn Lite Pac Pearl has a thermal conductivity of 0.031W/mK, making it one of the most efficient expanded polystyrene boards on the market.

### Environmental

Quinn Lite Pac Pearl insulation is manufactured from EPS (expanded polystyrene) and achieves an A+ rating in the BRE Green Guide to Specification.

## Applications

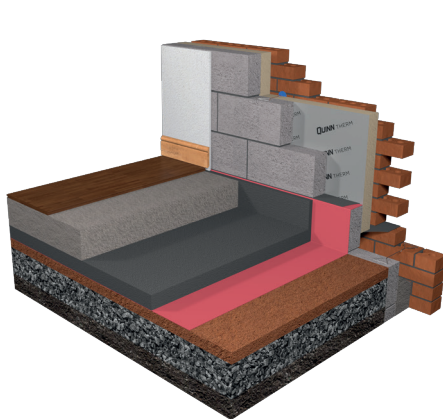

Solid ground floor:  
QF below groundbearing slab

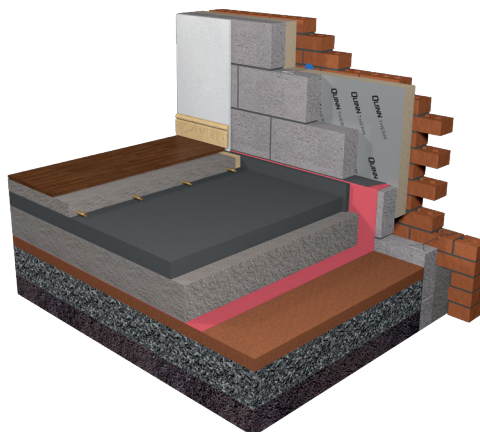

Solid ground floor:  
QF above groundbearing slab

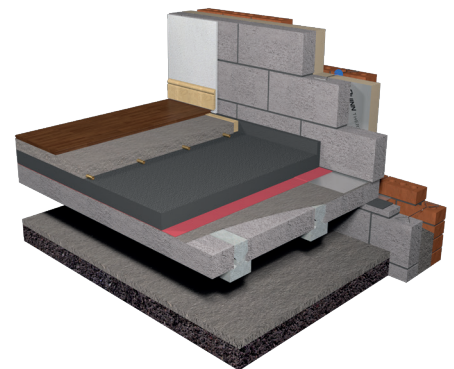

Suspended beam and block floor

## CE Marking



Construction Products Regulation (CPR) requires mandatory CE marking for all thermal insulation products. Quinn Lite Pac Pearl boards are CE marked to harmonised standard EN 13163. The Declaration of Performance, 04/013+, is available on our website (see bottom of page for link)

## Delivery & Storage

Quinn Lite Pac Pearl boards are shrinkwrapped in polythene for delivery to site. Each pack is labelled with the product description, product characteristics, manufacturer's name and brand name, quantity per pack, and any identification marks.

## Biological / Chemical

Quinn Lite Pac Pearl EPS insulation is non-toxic and non-biodegradable. Quinn Lite Pac Pearl EPS will not sustain mould growth and offers no nutrient value to insects or vermin.

## Technical Support

Quinn Lite Pac provides a comprehensive technical support service for designers and contractors.

### Quinn Lite Pac can provide:

- Copies of Agrément certificates
- U-value calculations
- Interstitial risk calculations
- Design advice
- Guidance on the most effective ways to meet current Building Regulations and Building Standards.

### Contact Technical Support:

- Call: +44 (0) 28 6774 8866
- Email: [technical@quinn-buildingproducts.com](mailto:technical@quinn-buildingproducts.com)

## Physical & Performance Characteristics

Compressive strength at 10% deformation (kPa):	70/100
Bending Strength (kPa):	115/150
Dimensional stability:	DS (N) 5
Thermal conductivity	0.031
Long term water absorption	WL (T) 05 (less than 5%) less than 1%
- total immersion	
- partial immersion	

## Fire Performance

Solid ground floors are not required to provide fire resistance. When properly installed Quinn Lite Pac Pearl is fully protected by the concrete slab and will have no adverse effect on the fire performance of the building into which it is installed.

Quinn Lite Pac Pearl is supplied as non-flame retardant material as standard.

## Dimensional stability / Durability

When tested to EN 1604 Quinn Lite Pac Pearl achieves level DS(N)5 to EN 13163.

Quinn Lite Pac Pearl will perform for the service life of the building.

## Design and Installation

For design and installation information plus thicknesses of Quinn Lite Pac Pearl to achieve specific U-values in all floor applications, consult our Product & Installation Guide, available from Quinn Lite Pac or via our website.

### For further information:

Quinn Building Products Ltd, Derrylin, Co. Fermanagh, Northern Ireland BT92 9GP

t: +44 (0) 28 6774 8866 | [www.quinn-buildingproducts.com](http://www.quinn-buildingproducts.com) | [info@quinn-buildingproducts.com](mailto:info@quinn-buildingproducts.com)



Every effort has been taken in the preparation of this data sheet to ensure the accuracy of representations contained herein. Recommendations as to the use of materials, construction details and methods of installation are given in good faith and relate to typical situations. However, every site has different characteristics and reliance should not be placed upon the foregoing recommendations. Advice can be given as to specific applications of the products, upon request to Quinn Lite Pac.